

CONTENTS

TYPE: SDL-K0402

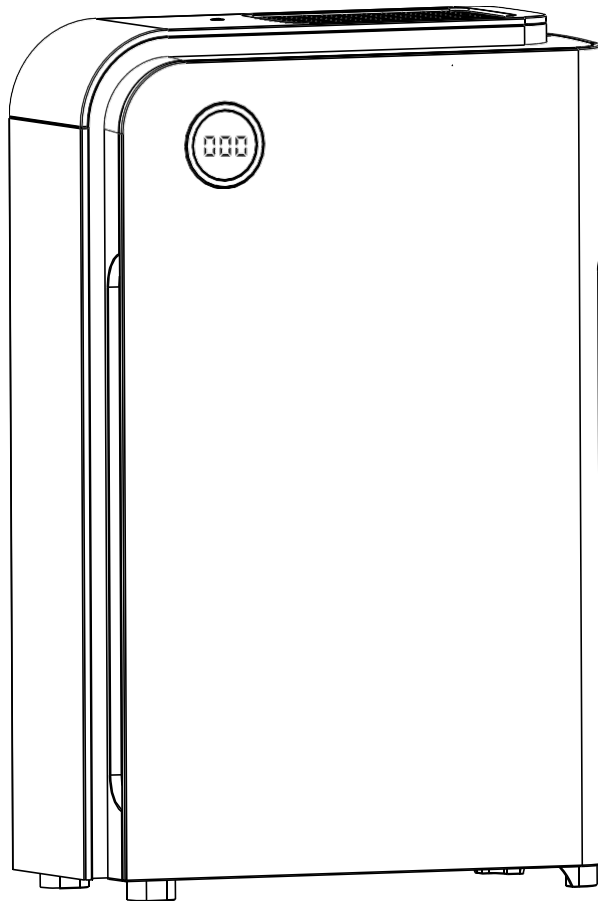

operation manual

1 Security note	3
------------------------	----------

2 Product Introduction	5
Control panel	6
Other items in the package	6

3 Before use	7
Record the beginning use date in the label	7
Learning air quality indicator	7
Method of dismounting and installation	8
Placement sites of Air Purifier	8
Install filters	9
Filters and functions	11

4 How to use	13
The control panel	13
Starting air purifier	14
Auto mode	14
Night mode	14
Silent mode	14
Wind speed adjustment	14
Negative ion	15
Ultraviolet	15
Timing functions	15
Air quality indicator	15
Reset	15

5 Cleaning and Maintenance	16
Clean air purifiers	16
Clean air quality sensors	16
Clean pre-filter	17
Replace filters	19
Time for replacement of filters	21

6 Fault handling	22
Warranty and service	23
To order parts or accessories	23
Accessories	23

7 Additional information	24
Recycling	24
Specifications	24

8 Warranty description	25
-------------------------------	-----------

9 Warranty card	26
------------------------	-----------

operation manual

1 Security Note

In order to avoid possible damage to you or others or financial damages, please be sure to pay attention to the following safety precautions.

If the machine's power supply cord is damaged, you must entrust the manufacturers of the machine, maintenance service center or qualified technicians will change for you, in case of any danger.



Warning



No wet hands!

Don't touch the power plug with wet hands.

Otherwise it may cause electric shock.



Pull the plug!

Before cleaning appliances, please make sure have power off.

Otherwise air purifier may run suddenly, cause accident getting an electric shock.



It is prohibited to use beyond power or connected devices specified value. Only 220V dc power allowed.

Banned! Using universal socket or exceed the specified value of the equipment may cause overheating and fire accident.



Before start the air purifier, please insert the plug completely into the socket.

Failure to fully inserted into the socket may cause electric shock and overheating or fire accident.

- Do not use damaged plug or loose power socket.



No damage on the power line and socket.

Banned! In the use of the machine, don't bind wires. Use the broken wire may cause electric shock, short circuit or fire accident.

- Ban cut, modification, excessive distortion, torsion, pull wire, or put weight on wires or plugs.



Please clean power plug regularly.

Accumulation of dust on the power plug and the moisture can damage the insulation of the plug part, resulting in fire accident.

- Pull out the power plug, then wipe with dry cloth (ban using wet cloth!).

- Remember to pull the power plug if not use for a long time.



Prohibit unauthorized apart or modified the air purifier.

Banned take apart

Otherwise it may cause electric shock, failure or fire accident.



Ban rod or other metals placed in the outlet or inlets.

Banned!

Otherwise it may affect the internal parts and cause electric shock or damage.

operation manual

Attention

Any situation as below, please turn off the power of the machine.

A switch does not work.

A circuit breaker or fuse burned.

The power cord or plug abnormal fever.

Finding the burning odor or abnormal sound or vibration.

Any other anomalies or failure.



Attention



Prohibited use solvent such as benzene or thinner to clean air purifier, avoid touching with insecticide spraying.

Banned!

Otherwise air purifier can rupture and cause damage, even short circuit, so that cause electric shock or fire accident.



Pull out the power plug, should hold the plug, instead of pulling wires.

Otherwise it may cause short circuit, wire and cause fire or electric shock accident or injury.



Ban in place for being fat particles using this air purifier.

Banned!

Such as inside the kitchen, can reduce the service life of air purifier filter.

- The air purifier should not be used for ventilation or extraction equipment.



Banned in high temperature, damp or wet body sites using this air purifier, such as the bathroom.

No wet!

Air purifier may leakage caused electric shock or fire accident.



Banned use the air purifier in indoor with fumigation type pesticides.

Banned!

Chemical residue could be accumulated inside the machine, and then release from the outlet to harm health.

- After using pesticides, please let thoroughly ventilated room, before using the air purifier.



Do not put the volatile substances or combustible materials, such as tobacco or Mars to float into the machine.

Away from the fire!

Away from the fire! Otherwise it may cause fire accident.



Wet body is prohibited.

No wet!

Otherwise it may cause electric shock and fire accident due to short circuit.



This appliance can be used by children aged from 8 years and above and persons with reduced physical, sensory or mental capabilities or lack of experience and knowledge if they have been given supervision or instruction concerning use of the appliance in a safe way and understand the hazards involved.

Children shall not play with the appliance. Cleaning and user maintenance shall not be made by children without supervision.

2 Product Introduction

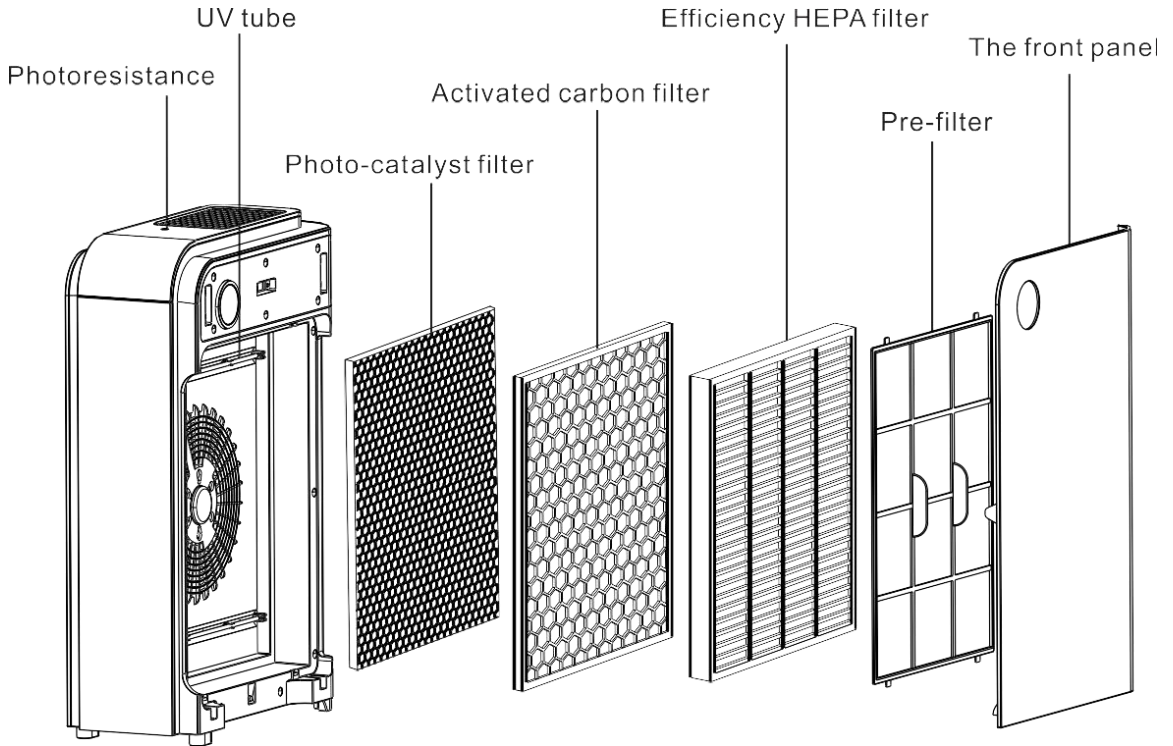
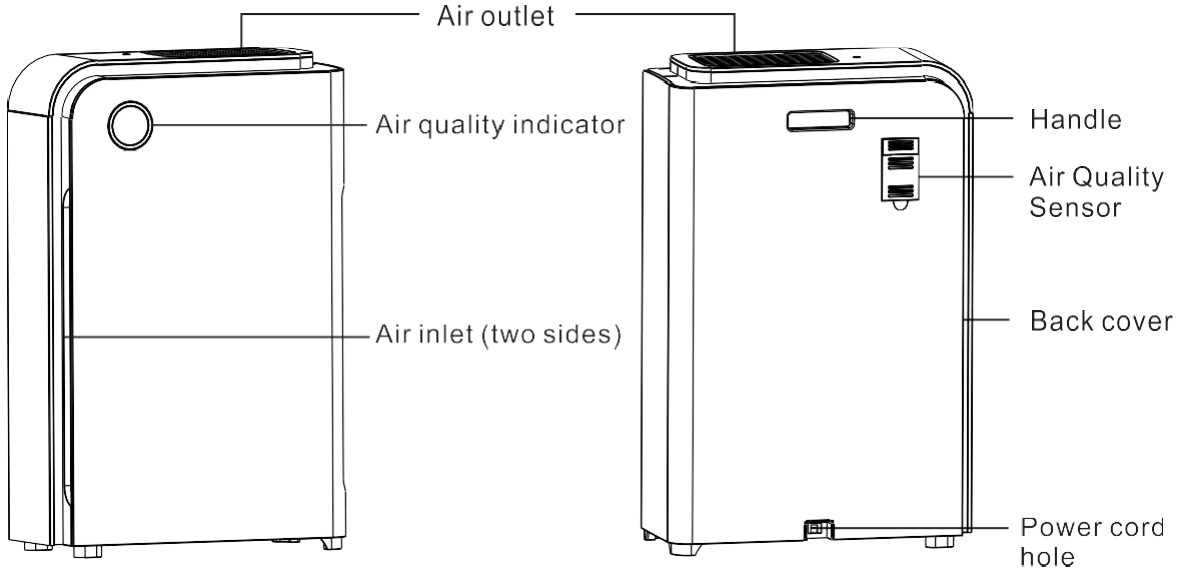

operation manual

Control panel

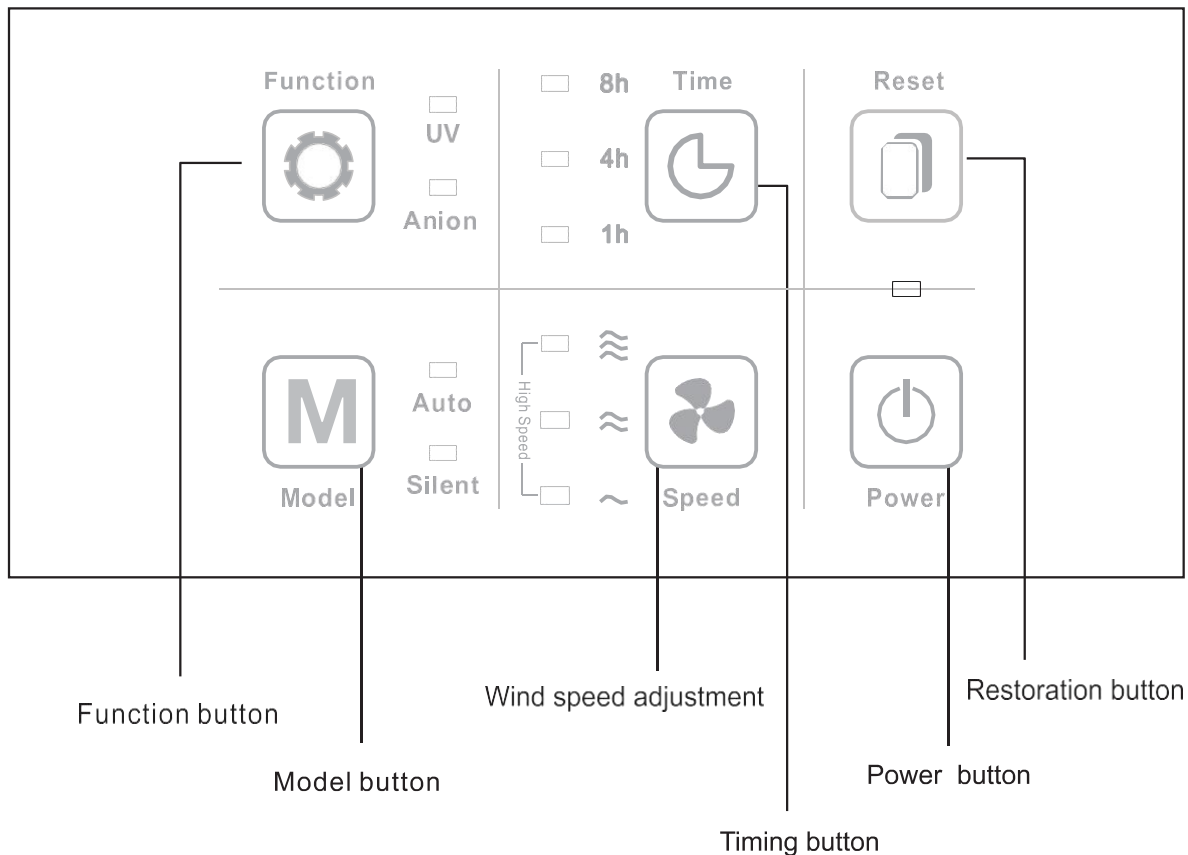

Other items in packing

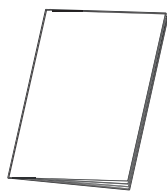

operation manual

Air quality indicator

	Blue (PM2.5= 0 ~ 50)	Perfect
	Green (PM2.5=50 ~ 100)	Good
	Purple (PM2.5= 100 ~ 150)	Normal
	Red (PM2.5=150 ~)	Bad

**Notice: please press the restoration button, if you want to turn off the air quality indicator light.
(PM2.5 digital display just for reference)**

operation manual

3 Before Use

Record the beginning use date in the label

In order to replace the filter on time, before using air purifier, please keep the date recorded in the back of the nameplate, thus to achieve the best performance.

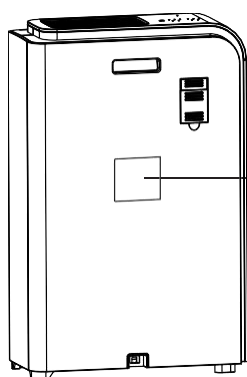

Nameplate and notes

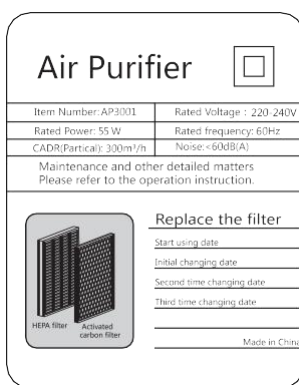

Noted the start and change date

Tips

After removing the plastic package of each filter, the efficient HEPA filter and activated carbon filter must be replaced once a year.

Photocatalyst filter should be replaced every three years, after a period of time, should exposure under sunlight more than 2 hours.

To know the air quality indicator

Air quality indicator can reflect the air quality conditions, please refer to the specific page 6 and page 14.

Air quality indicator
light and data both for PM 2.5

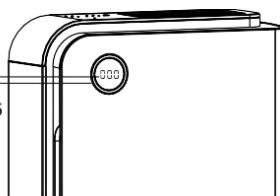

operation manual

Method of dismounting and installing the front panel

1 Method of removing the front Panel.

Hold on to the groove at both sides of the front panel, then gently pull it up.

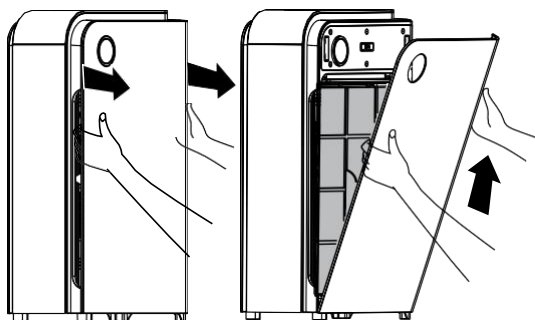

①

②

2 Method of installing the front panel.

Reinstall the front panel, alignment and insert it into the fixed groove, and then gently push it up.

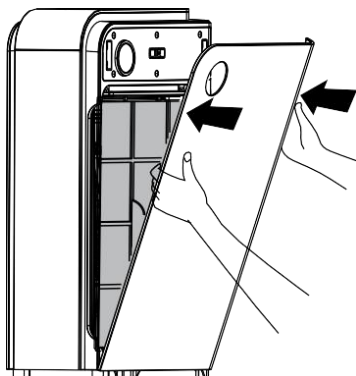

Placement sites of air purifier

In order to make your room air to achieve good effect on both sides of the cycle, to ensure the gap between the air inlet and the wall at least 50 cm, the air outlet at least 10 cm.

Please keep 1 meters away from television, radio, etc.

Please do not put the power plug together with the television, radio and other electrical power plug inserted into the same socket. (otherwise it may cause screen jitter and noise generated.)

- The long-term placement in the same sites may dirty the host walls.
- To ensure the machines have adequate ventilation and maximum efficiency, don't interfere with the air outlet and air inlet.

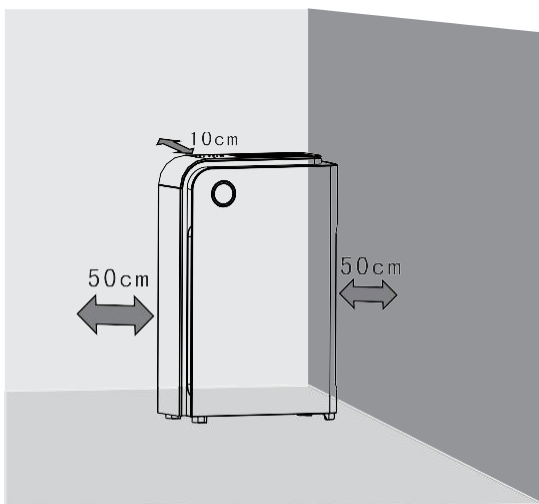

operation manual

Install Filter

Information

Please remove all the package of all the filters in the machine before using the air purifier, according to the below instruction.

⚡ Attention

- Please make sure the power plugs have been put off before installation, maintenance and transportation.
- Please do not operate the air purifier without the filters.
- Please remove the package of each filter before using.

💬 Tips

You can put the purifier on the wall to enhance the stability when removing or installing the filters.

Steps

Initial use this air purifier, please install the filters correctly as below instructions.

1. Please remove the all packages and put the purifier on the dry, stable, horizontal ground.

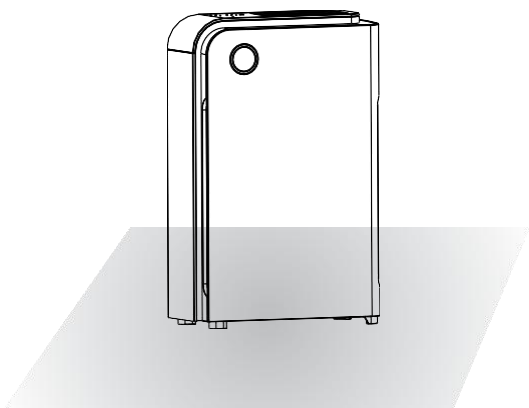

2. Hold on the grooves at both sides of the front panel, then gently pull it up.

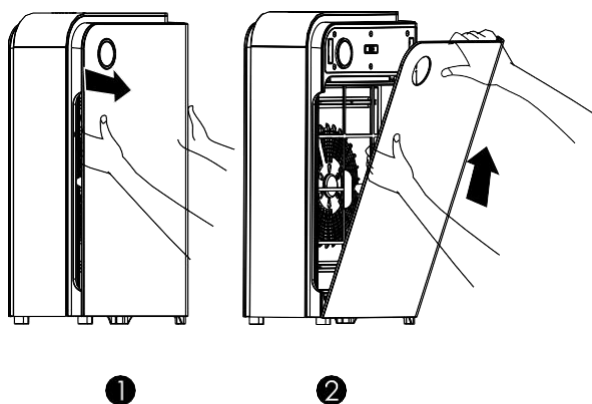

3. Take out all filters and UV lamps from this purifier.

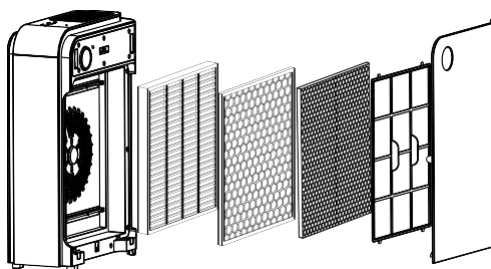

4. Remove all packages.

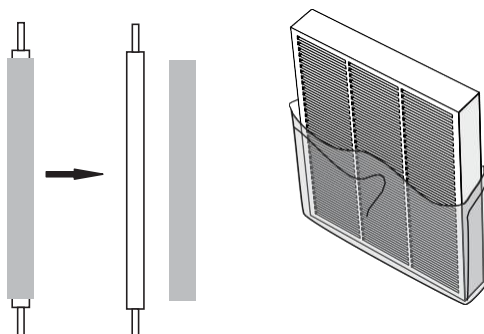

operation manual

5. Hold the two ends of the UV lamps and put the needle into the metal groove. please enter the metal groove with the flathead screwdrive until the aperture coming. Then please screw gently the needle of the UV lamp in it. please operate another end with the same method.(please do not enter it in forcibly.) Later please install the filters one by one.

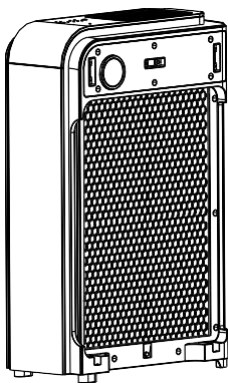
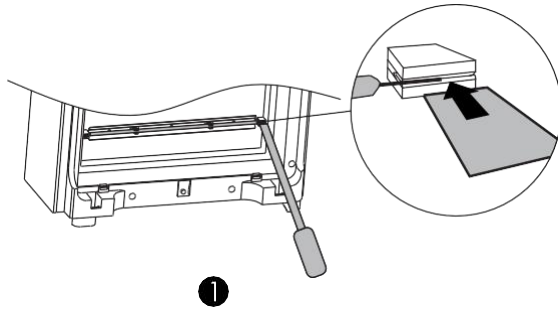

6. Install the pre-filter as the instruction.

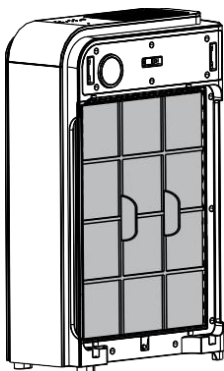

7. Install the front panel again. Align and insert it to the fixed grooves, then gently push it.

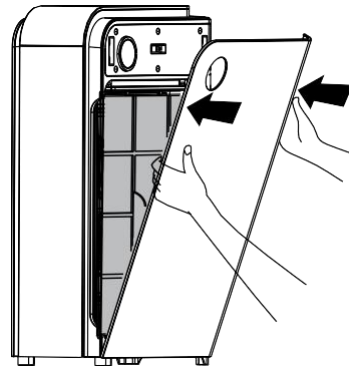

Tips

Please be carefully when install the front panel.

operation manual

Filters and function

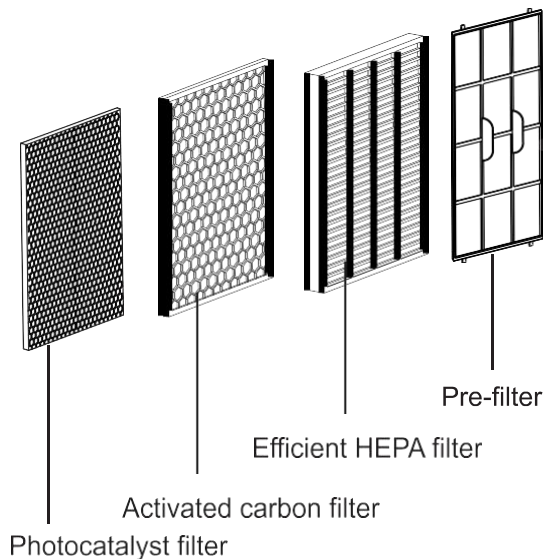

6 points purification system, could effectively purify the air, make life more healthy.

One: Pre-filter

Two: Efficient HEPA filter

Three: Activated carbon filter

Four: Photocatalyst filter

Five: Anion

Six: UV light, effective sterilization

One: Pre-filter

Use micron mesh filter, effectively block 2.5mm fibrous particulate matter, Blocking rate > 99.9%. It can be cleaned easily by tens of thousands times.

Preventing larger particles such as pet fur, dander and coarse dust, etc. Can increase the life of the following filters.

Two: Efficient HEPA filter

The rate of removing the minor particles small to 0.3 micron from the air flow can up to 99.9%

Spread of allergens and bacteria in air flow, such as pollen, smog and viruses

Three: Activated carbon filter

Removing volatile organic compounds, such as secondhand smoke and kinds of polluting gases.

Four: Photocatalyst filter

Use Nano TiO_2 as representative materials, has photo-catalytic function, under the role of UV light, it will have a strong catalytic degradation.

Effective degraded of formaldehyde, toluene, xylene, ammonia, TVOC and other pollutants.

operation manual

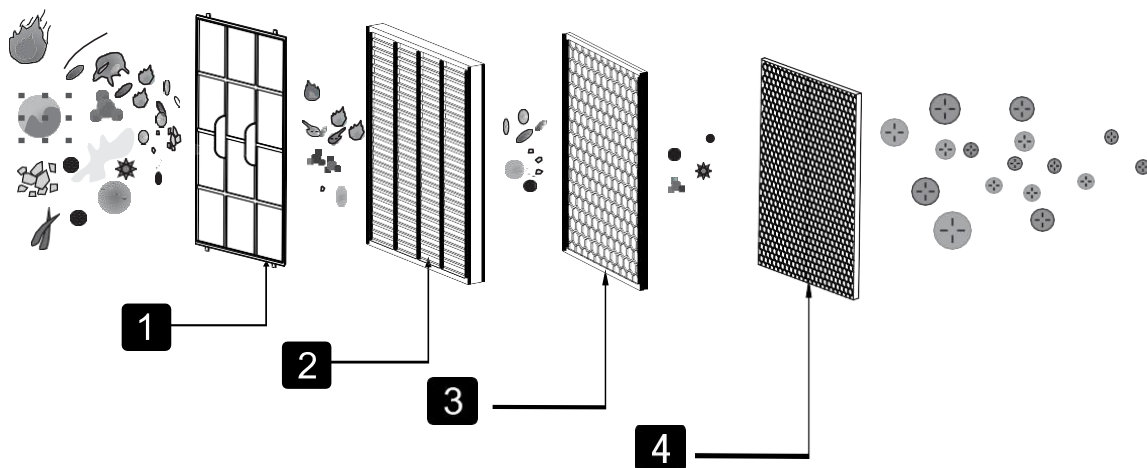

Five: Anion

Produce large amounts of negative ions, physical adsorption, eliminate odors, has a strong adsorption.

Six: UV light, effective sterilization

Effectively kill a variety of common bacteria and viruses, inhibit the production of bacteria and viruses.

Tips

Cold cathode UV lamp trigger voltage is only 500v, will not produce ozone, can use it safely.

+ The allergens



Coarse dust



Hair



Harmful particles



Dander



Dust



Pollen



Pet fur



Smoke



Dust mites



Odor



Chemical substances

+ Bacteria



Yeast



Mycotic spore



Virus



Mildew



Mould



Bacteria

operation manual

4 How To Use

Control panel

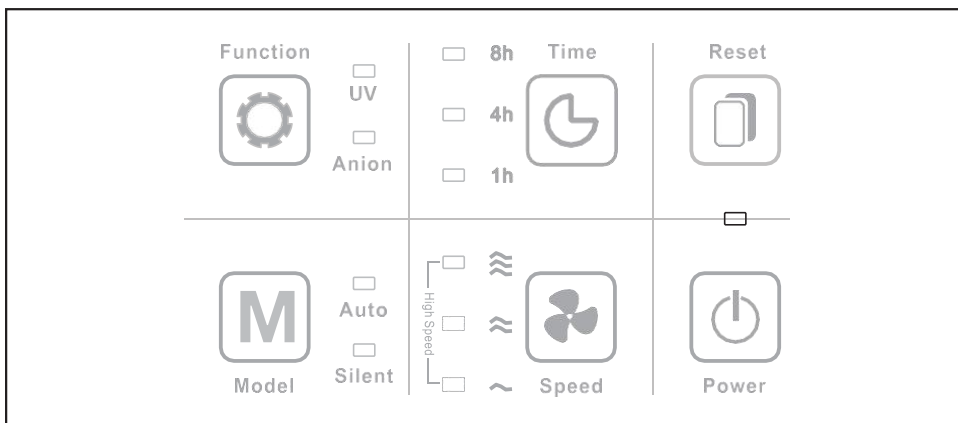

Plug in the power

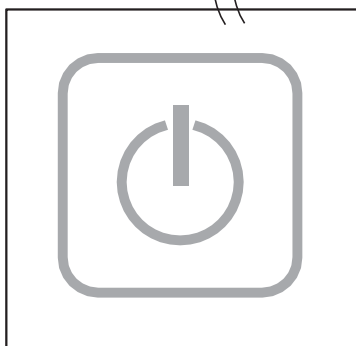
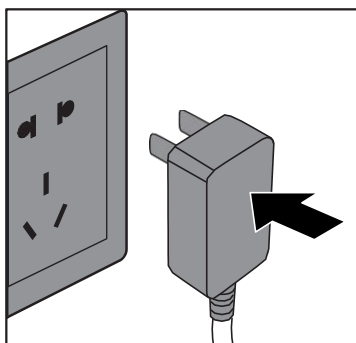

Plug in the power, the music starts and all the lights flash 3 times continuously, then all the lights off, leaving only the power indicator light in red, entering the standby mode.

Starting air purifier

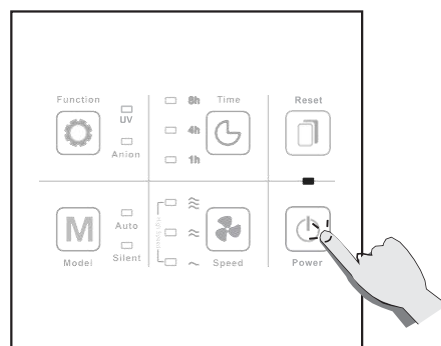

Press the power switch to enter into auto mode with the lights on.

When the machine starts, the air quality indicator light will be slow flashing on, it begins to detect the air quality after preheating for 30S.

When auto mode starts, it will detect the air quality automatically.

operation manual

Air quality indicator

 Blue (PM2.5= 0 ~ 50) Perfect

 Green (PM2.5=50 ~ 100) Good

 Purple (PM2.5= 100 ~ 150) Normal

 Red (PM2.5=150 ~) Bad

Notice: please press the restoration button, if you need to turn off the air quality sensor light.

Auto mode

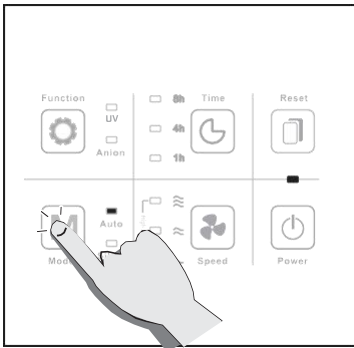

Turning the power on, it will detect the air quality automatically. Choosing the auto mode, will give you the most appropriate fan speed.

Night mode

Night mode, have build-in radial sensor, which will sense the strength of the light, if the light intensity is under the condition of insufficient, all lights of the machine will be dimmed, and at the same time, the machine automatically change to silent mode of operation, do not disturb your rest at night.

Night mode can only be used together with the auto mode.

Silent mode

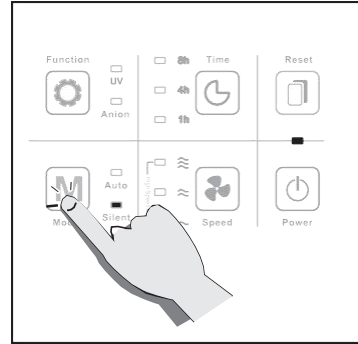

It operates with low noise in silent mode.

Wind Speed adjustment

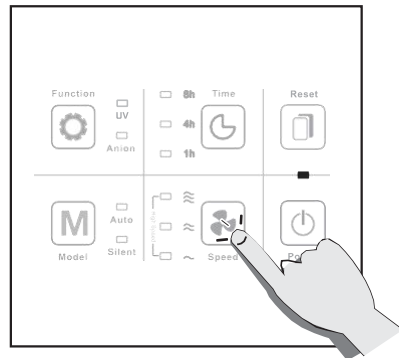

The four lines above indicates four different speed.

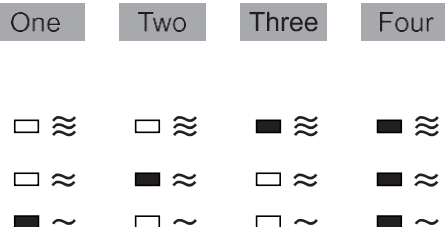

operation manual

Anion

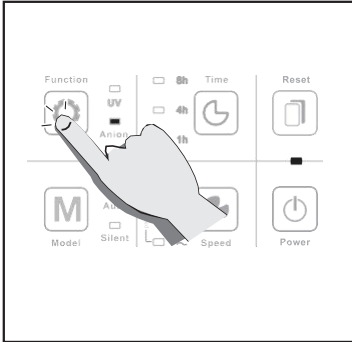

Air quality indicator

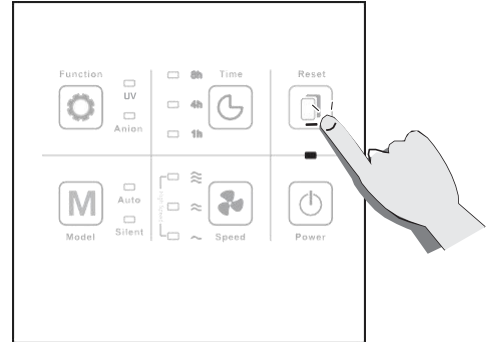

Flip this button to open/close air quality indicator.(light and data both for AP3001B Style)

Ultraviolet

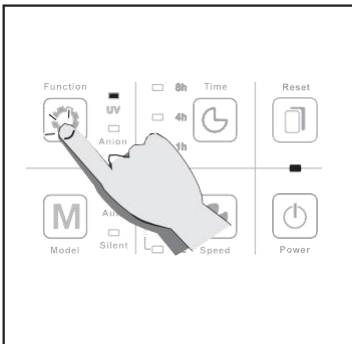

Reset

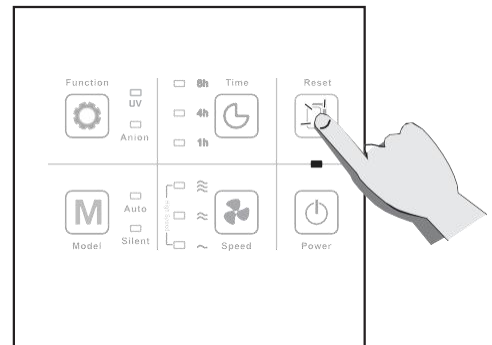

Reset the machine by pressing the button for at least five seconds,(This function is only available after the replacement remind of filter).

Timing function

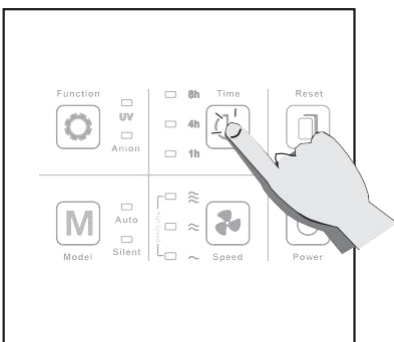

Attention

when air quality is poor indoor, it need extra strong airflow,Choose enhanced wind speed airflow.When the enhanced fan speed is activated,all the LED light of wind speed will be lighten up .

operation manual

5 Cleaning And Maintenance

Be sure to pull out plug before cleaning.

Do not put the product into water or any other liquid. Do not use corrosive or flammable gas (e.g. bleach or alcohol) to clean any part of the product.

Only pre-filter can be cleaned with water, other filter can't.



Clean air purifier

Clean the medial and lateral regularly to prevent dust accumulation.

- 1 use soft dry cloth to wipe the dust .
- 2 use soft dry cloth to clean inlet and outlet.

Clean air quality Sensor

Clean the air quality sensor every two months to make sure purifier run at the best performance. If the purifier used in dusty environment, please clean it more often.

Attention

When the indoor humidity is very high, the air quality indicator may be forming condensate. So even if the air quality is good, air quality indicator may also indicate poor air quality, in this case, you have to clean the air quality indicator or use any manual speed setting.

1. Using a soft brush to clean the inlet/outlet of air quality sensor

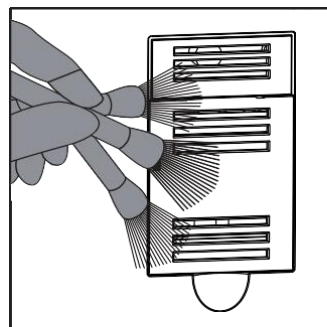

2. Remove the protective cover of air quality sensor.

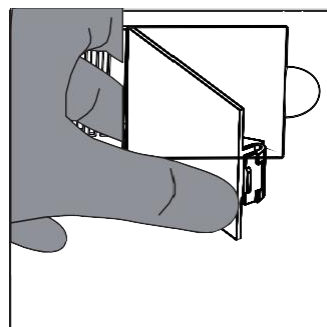

3. Clean the air quality sensor, inlet and outlet with wet cotton swabs slightly

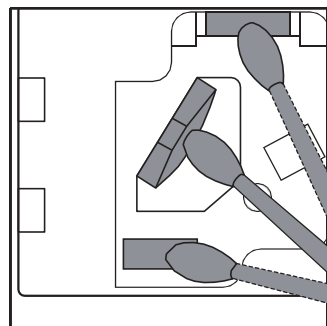

4. Dry it with dry cotton swabs.

5. Remount the protective cover of air quality sensor.

operation manual

Clean the pre-filter

Information

In order to achieve the best performance , clean and maintain the Pre-filter every two months (about 480 hours) from the beginning to use.

Based on the average 8 hours a day , 7 days a week frequency , keep the machine working under the household environment.

External maintenance : use wet cloth(or the mild detergent)to wipe the surface to prevent the accumulation of dust.

Turn off the air purifier and pull out the plug before cleaning and maintenance.

Only the Pre-filter can be cleaned,other filters can't.

⚡ Attention

Please use the low power vacuum cleaner, preventing the filter from damage.

💬 Tips

Before putting each filter into the machine pls remove the plastic packaging, and ensure that the labels on the filters are outwards.

Operation steps

1. Turn off the power to stop the air purifier.

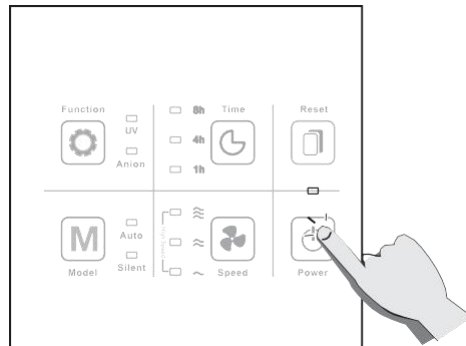

2. Pull out the power plug.

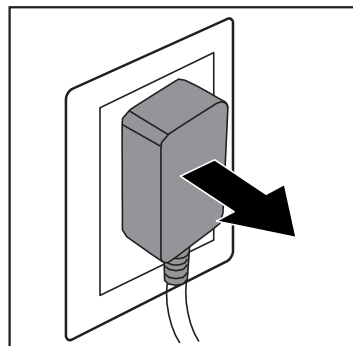

3. Hold on groove at both side of the front panel and pull it outward, then remove it upwards.

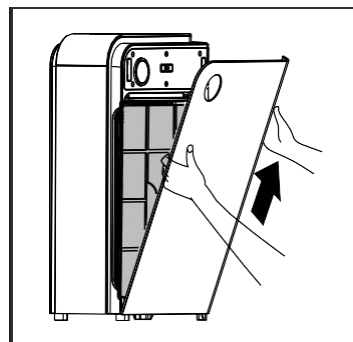

operation manual

4. Removed the protruding part of the gauze filter before cleaning it.

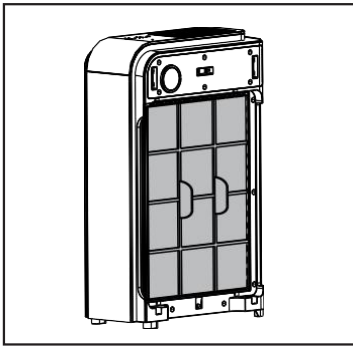

5. Use a soft brush or a vacuum cleaner to remove particles. please use water or soap water to clean the filter. then place it into the machine when it is completely dry

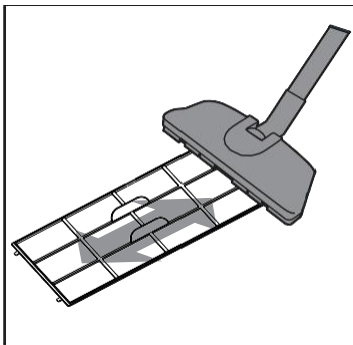

6. Put back the pre-filter into the air purifier.

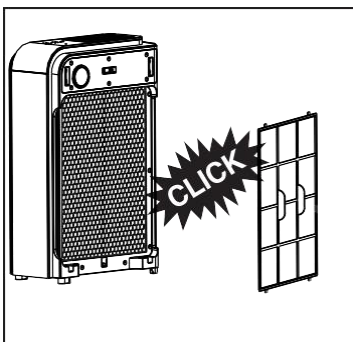

7. Re-install the front plate, align and insert into the fixed groove, then gently pushed it up.

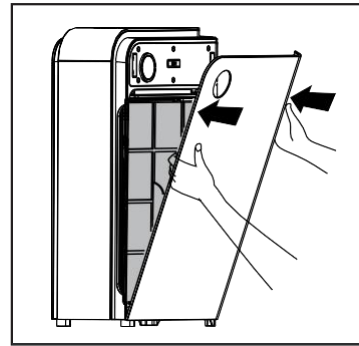

8. Plug in.

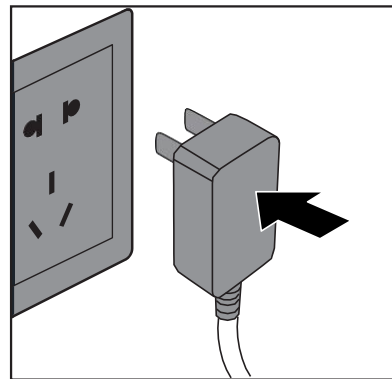

9. Turn on the power and start the air purifier.

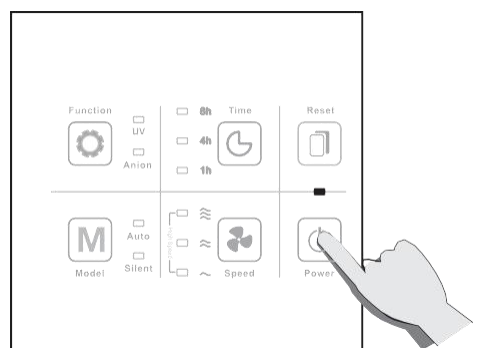

operation manual

Replace filters

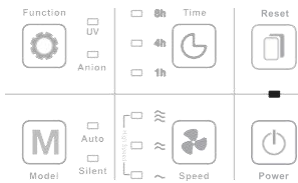

A reminding of filter replacement comes when machine in normal working for more than 1600 hours, and the power lights flash slowly (the red lights flashing, when standby, the blue lights flashing when it is working).

After the indicator light of replacement of filter shows, the machine can still work.

⚡ Attention

Please turn off the power and pull out the power plug before replacing the filter.

💡 Tips

Remove all the plastic packaging of each filter before put into machine, To ensure the filter label is outward.

Operation

1. Reminding to replace the filter.

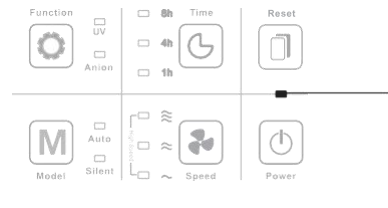

Flashing

2. Turn off the power, then pull out the power plug.

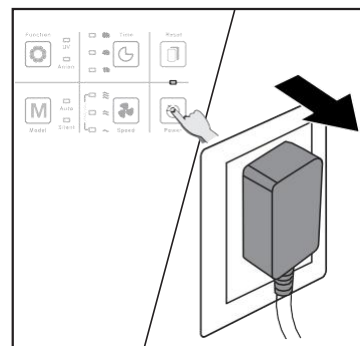

3. Hold on the grooves of both side of the front panel, then gently pull it up.

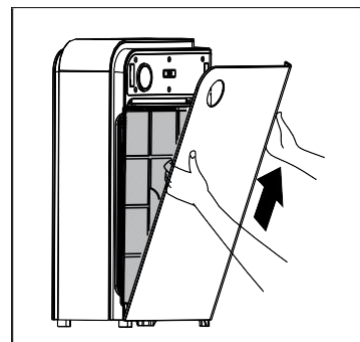

operation manual

4. Take off all filters inside.

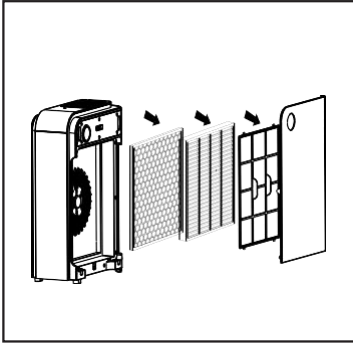

7. Re-install the front panel, keep alignment and inserted into the fixed groove, then gently push it up.

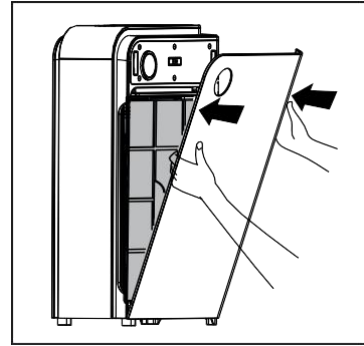

5. Remove all the plastic package of the filters, put back into the purifier.

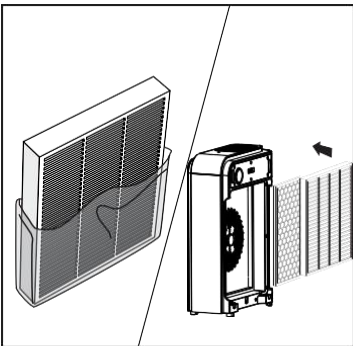

8. After replacing the filter, plug in power, hold on the reset button for 5 seconds, then machine resets.

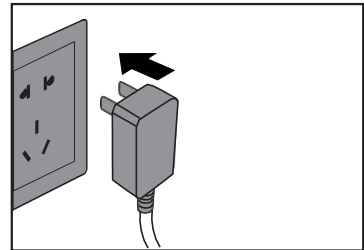

6. Put back the pre-filter into the purifier.

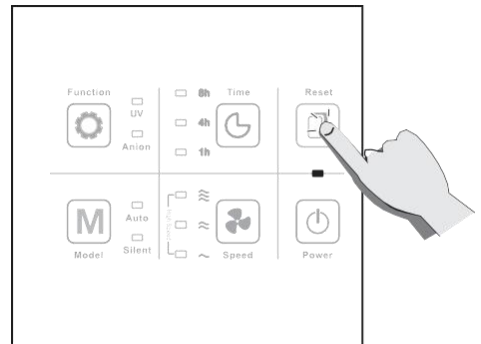
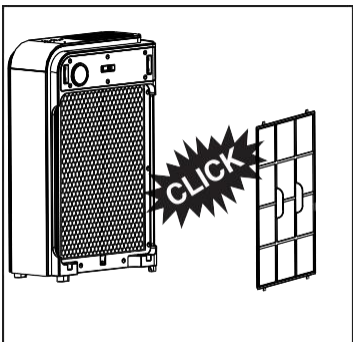

operation manual

Unused for a long time

Pull out the power plug.(because the power consumption happened when it is standby.)

Thoroughly dry the inside.(otherwise it may lead to the equipment trouble.)

Store the machine in a dry ventilated place.(lay flat or place upright down may lead to the product trouble.)

Replace filter reference time

When the total machine work time reach to 1600hours, the machine will notice to change the filter . The power indicator will flash ceaselessly(one time per second). The red light showed when it is standby, the blue light showed when it works. But the machine still can work when get the notice of changing the filter.

Tips

- 1.Consider you and your family's health, please change the filter screen in time.
- 2.After sealing off filter,if the usage time is shorten. But suggest to change one time per six months.
- 3.After sealing off filters, the filter should be changed one time per 12 months.
- 4.Photo-catalyst can be changed one time per 3 years. But it should be exposed under the blazing sun usually.
- 5.After 1000hours of usage for UV light, sterilization efficiency will reduce to 70% around. But it does not affect the efficiency to resolve the volatile organic compound, such as formaldehyde, TVOC, etc.

Attention

Please turn off or Pull out the plug, before you change the filter .

6 Fault Handling

This chapter list the possible problems when using this product. If you can't solve the problems based on the below information, please contact with our customer center or dealers.

condition	possible reasons	possible solutions
Machine can't turn on	The front panel may not be installed.	To remove the front panel, then install the panel again.
	Power plug is not inserted into the power source	Pull out the power plug, then insert into the power source.
	The power plug or wire is damaged.	Contact with our customer center or dealers.
The fan doesn't work	The machine is not turned on.	Insert the power source, and turn on the machine again.
	The dynamo is damaged.	Contact with our customer center or dealers.
	The machine is put on the uneven place.	Remove the machine to the flat place.
	Loose or foreign particles inside the machine.	Contact with our customer center or dealers.
	The motor is loose.	Contact with our customer center or dealers.
	Plastic packaging of each filter is not removed.	Before using, please remove plastic packaging of each filter.
Performance is poor or not best purification ability	Washable mesh filter is dirty.	Please clean the cleaning mesh filter.
	Filter is not replaced.	Replace one set of new filter.
	Machine inlet or outlet was blocked.	Contact with our customer center or dealers.
	Plastic packaging of each filter is not removed.	Before using, please remove plastic packaging of each filter.
	The gap round the machine is not proper	To ensure the machine at least 50 cm clearance on both sides of the air inlet and the outlet at the back of the machine at least 10 cm.
	Machine filter missing or sequence error	To ensure that all the filters put the correct sequence in machine
	Exceed the expect cover area	To ensure the machine work in the suitable area

operation manual

Warranty and service

If you need to understand information or have any questions, you can also contact our customer service center or dealer.

Product warranty terms refer to the instruction attached warranty card in detail.

Ordering parts or accessories

If you need to replace parts or need to purchase additional parts, please contact your customer service center or dealer.

Select Accessories

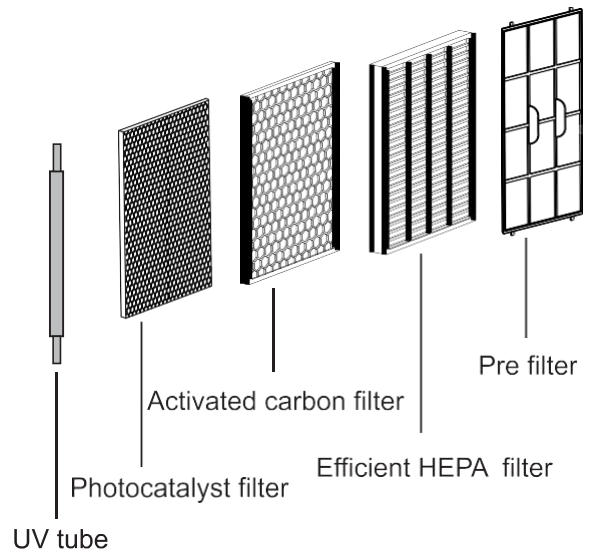

7 Additional

recycling



Place the product, please don't put together with the general life garbage. Please check the local regulations on classified collection of electronic and electrical products.

Right place old product helps to avoid the potential negative effects on the environment and human health.

Machine parameters

Model: FY-A06

Rated Voltage: 220-240V/110V-120V

Rated frequency: 60Hz

Rated Power: 55W

CADR(Partial) : 300m³/h

Noise: < 60dB(A)

8 Warranty Description

According to the stipulations of the "new three guarantees", the machine warranty period is one year (from the date of invoice) (warranty range only used for family).

1. During the warranty period. All that is the quality of the product itself caused by fault, please service with complete product warranty certificate and upgrade free maintenance order of invoice in my company branch.

2. Please keep upgrade invoice as proof of warranty with the warranty certificate, once the invoice is altered, the warranty is invalid.

3. Passed the warranty period, if you need a mail-order products, spare parts, can with your company's customer service mail order, also can buy in the local branch.

4. If the specifications have a fixed number of year of the warranty commitment, subject to our manual.

Have no free services and repairs if occurred below situation

1. Without three guarantees proves and effective invoice.

2. The malfunction is caused from operating machine without follow the requirements of specification.

3. One of the following circumstances don't belong to the warranty scope:

a: Consumers use, custody, maintain improper and cause damage.

b: Not the company designated maintenance department to repair damage caused by themselves.

c: Damage caused by force majeure.

4. Products does not belong to the warranty scope, our company's customer service also enthusiasm serving you.

9 Warranty Card

Product name/item No.		Fuselage number	
-----------------------	--	-----------------	--

Purchase Date	Shop name	Phone number	
			Dealer stamp

Name	
Address	
Mobile Phone	
Zip Code	

Maintenance record
